



The Original True Cone 10 Kiln

## **Operation of the Vent Master**

- Turn the Vent Master on whenever the kiln is firing.
- Open the top peephole (both top peepholes for an oval kiln) only and leave it open whenever the Vent Master is operating.
- This provides the necessary replacement air.
- It is important that you do not open any other peephole.

## **Installing Vent Master**

Cone Art recommends the Vent Master be installed on the back of the kiln directly opposite the peepholes. If you are ordering a new kiln, your kiln can be predrilled from the factory to simplify the process. If your kiln has been predrilled for a vent, skip steps 1 and 2 and go directly to step 3.

### **Step 1**

Determine and mark the location of the exhaust hole.

One 3/8" diameter hole should be drilled in the back of the kiln directly opposite the peepholes, avoid damaging the heating elements. From the inside of the kiln, the hole should be located in the center of the wall, 4 1/2" above the floor. It is best to first locate and mark the spot on the inside of the kiln. Once the hole location is determined measure the distance from the top of the kiln wall to the desired hole location. Transfer that measurement and mark the outside of the kiln where the hole should be located.



## Step 2

### Drill Hole

Using a 3/8" drill, drill a hole through the back of the kiln in the location you marked in step one. The hole will need to go through the sheet metal and the refractory brick so that air can move from inside the kiln to the outside of the kiln. A pencil can be used to confirm that the hole goes completely through the kiln wall.

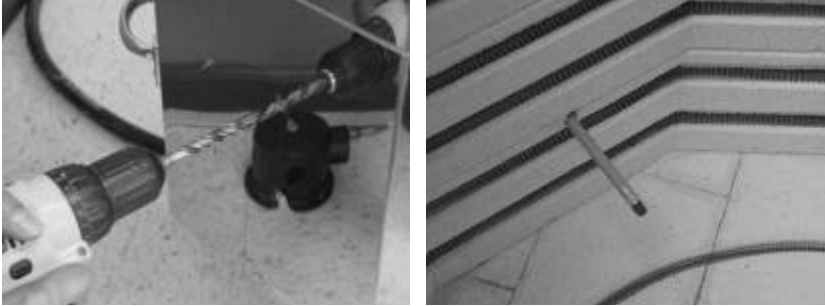

## Step 3

### Attach the Collector Cup

Using self tapping sheet metal screws, center the Collector Cup over the hole drilled in step two. Point the exhaust connector in the desired direction. Attach the collector cup by using self tapping screws into each of the four holes in the flange of the collector cup. (The white gasket should be installed between the collector cup and the kiln).





**The Original True Cone 10 Kiln**

#### Step 4

Attach the black hose to the Collector Cup

Once the Collector Cup is attached, attach the black high temperature hose to the collector cup with the hose clamp.



#### Step 5

Attach the other end of the black high temperature hose to the blower assembly



#### Step 6

Attach the Motor blower housing to 4 ducting.

Using either 4" aluminum ducting or PVC, exhaust the kiln to the outside according to local building codes. **FOIL DUCTING SHOULD NOT BE USED.** The Maximum Length of ducting is 60' with elbows or 90' straight.



## Special Instructions for 10 and 16 cubic foot Oval Kilns.

In addition to the Vent Master, and "Expansion kit" which includes a second collection cup and high temperature hose should be installed.

The location of the exhaust holes should be 4 1/2" above the inside floor of the kiln as described in Step 1 above. The two collector cups should be located on the back of the kiln (see diagram below). One to the left of the center back brick and one to the right of the center back brick. Each Collection Cup should be centered over a 3/8" diameter hole. The two collection cups should be connected with the black high temperature hoses to the motor blower housing.

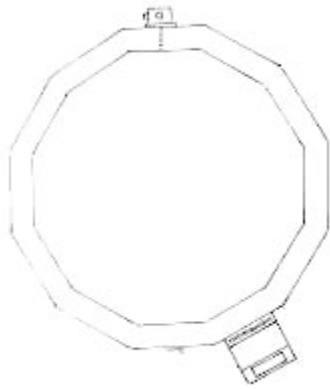

2827

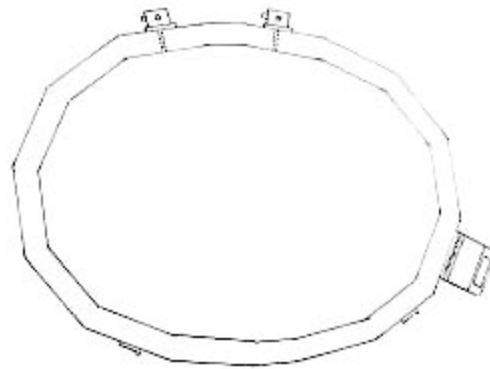

4227



The Original True Cone 10 Kiln

## Optional parts available for your Vent Master:

### Vent Master Hose Kit-M9 VMHK

Each kit includes 4 feet of black high temperature hose, hose connector and two 2" clamps. This kit is used to and 4 feet of length to the 4 feet of hose that comes with your vent. The total length of the black hose should not exceed 24 feet between the kiln and the blower housing.



### Vent Master Expansion Kit-M9 VMEK

Each kit includes 4 feet of black high temperature hose, collector cup, 4" Gasket and 2" clamps. This allows you to vent a second kiln or attach a second collector cup to a large Cone Art oval Kiln. This kit must be used along with the Vent Master.

